



# AIRWARE

AIR HANDLER HARDWARE

## ORDERING AND INSTALLATION GUIDE

### ORDERING GUIDE

1. Review your cone inlet size, select a damper width and height equal to or greater than the cone inlet. Our damper sizing is based on inlet diameter. So for example, the following damper would be a 13x13”.

2. Select a damper size with a velocity range of 1200-1800 FPM damper inlet velocity is recommended.

$$\frac{CFM}{SF} = FPM \quad \text{Example. } \frac{1500cfm}{\left(\frac{13' \times 13'}{144}\right)} = 1,282 FPM$$

3. Decide if you'd like our DOCK system or would prefer to manufacture your own.

\*Listed Air performance and leakage are based on use of the Airware DOCK.

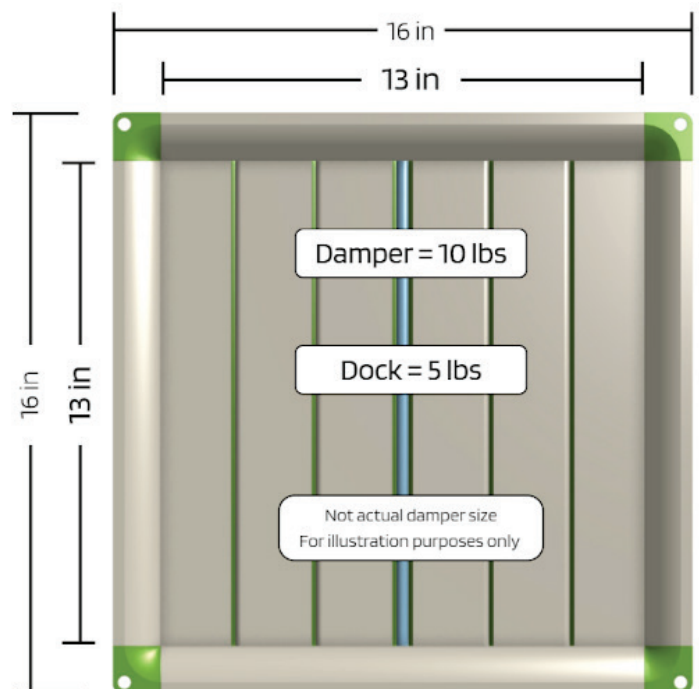

**For questions or recommendations, please email us at [sales@airwarehvac.com](mailto:sales@airwarehvac.com).**

## OPTION 1 | Airware Bracket Inserts (Recommended)

1. Punch or laser cut holes shown in figure 1. In the 13x13" example, the DH/2 and DW/2 would be 6.5". There are (8) holes total per damper, (4) primary bracket holes and (4) smaller guide holes. *Guide holes to be positioned towards the cone opening at a 45 degree angle..*

2. Install DOCK mounts and secure with provided fasteners. See Figure 2.

3. Using a 3/16" hex head bit and provided fasteners, attach the DOCK to all (4) brackets. Fastener should be installed until flush with top of bracket port. Be careful not to overtighten. The DOCK gasket should be fully engaged by both the Damper and DOCK. If gasket isn't engaged, please check that the set screws have been fully installed. See Figure 3.

4. Check that dock is level. *If damper is installed at an angle performance will be impacted!*

5. Orient your damper vertically. Attach damper to DOCK by repeating step 3. Be sure to check the gasket between the damper and DOCK to ensure it is full engaged. See below.

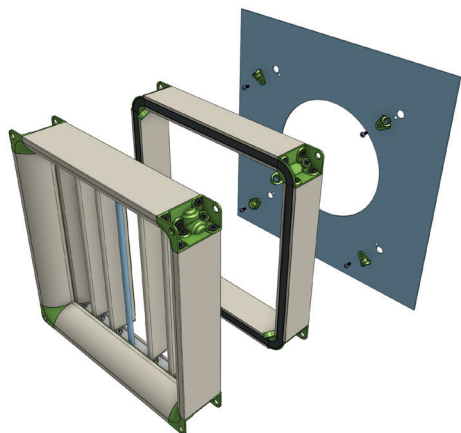

Figure 1:

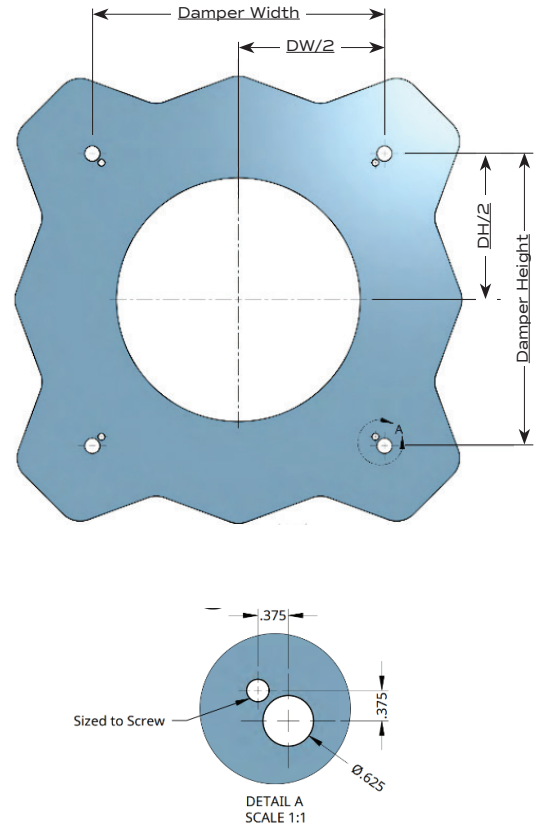

Figure 2:

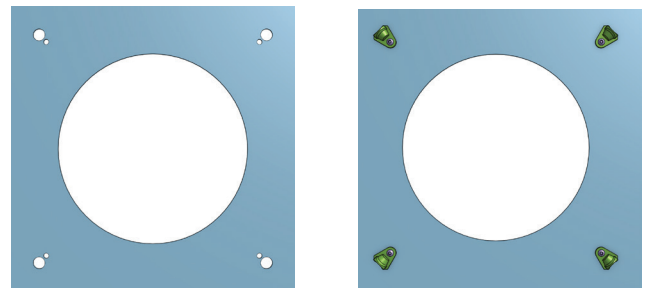
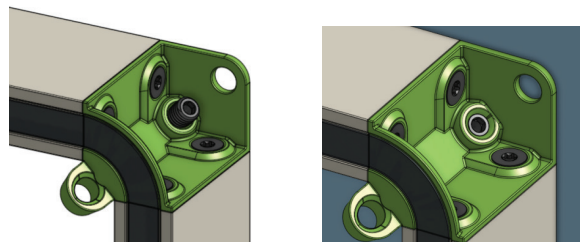

Figure 3:



## OPTION 2 | Perimeter Holes

1. The bolted option requires use of the following guide. Apply bolts in the locations shown in Figure 1.
2. Install DOCK to pressure wall and securely fasten. Similar to Option 1, step 3, make sure gasket is fully engaged. See Figure 2.
3. Check that dock is level. *If damper is installed at an angle performance will be impacted!*
4. Orient your damper vertically. Attach damper to DOCK by repeating step 3. Be sure to check the gasket between the damper and DOCK to ensure it is full engaged. See below.

Figure 1:

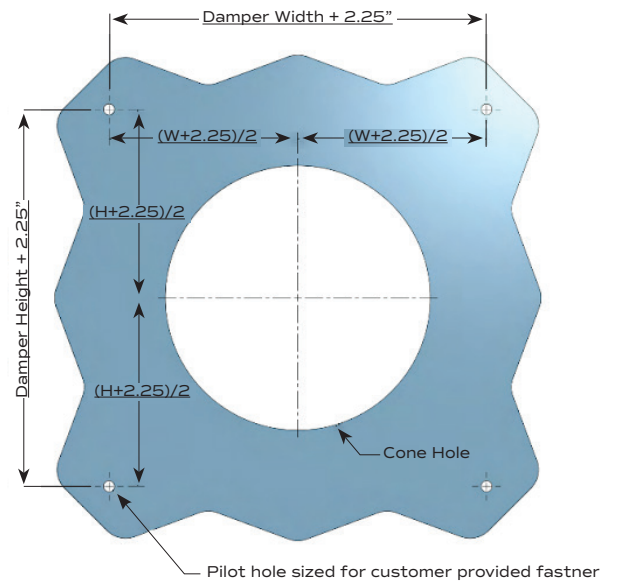

Figure 2:

